



# 46 OPEN

MAKE EVERY NAVIGATION  
A UNIQUE EXPERIENCE

**NAUTITECH**  
ELEVATE YOUR DREAM

# COMFORT

THE EXPERIENCE OF ELEGANCE

The well-designed, elegant and functional interiors, the huge panoramic windows flooding the lounge with natural light, and the comfortable benches invite you to savour every moment without limitations. Each cabin benefits of an unequalled natural light and a dedicated bathroom for more privacy.



# PERFORMANCE

A RACY LOOK AND  
HIGH PERFORMANCE

This catamaran is designed for thrill-seeking sailors with a perfectly balanced sail plan, a high sail area/displacement ratio and slim hulls to reduce the underwater area.

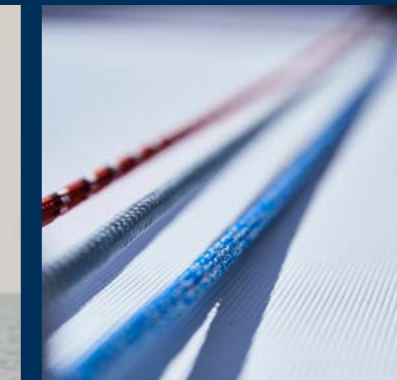
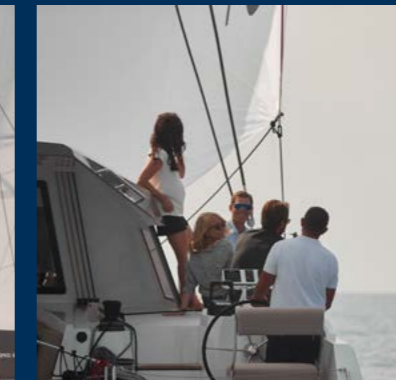
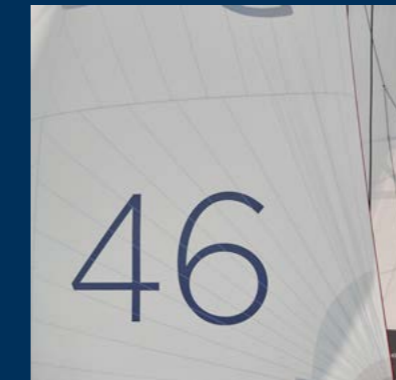

A superb view of the sea and the sails, whether upwind or downwind. Optimum mainsail area and easy furling with a lowered boom, and maximum helming sensations thanks to a short circuit line steering system. An enhanced safety for the helmsman thanks to a high aft bulwark and its direct link with the crew, as well as greatly facilitated dock manoeuvres. The double aft helm station, Nautitech's DNA, is the ideal position to enjoy the thrill of sailing under all circumstances.



The wide lounge area at the bow for lazing around or having an aperitif, the spacious aft cockpit connected to the galley for convivial get-togethers, the sofa area in the saloon for relaxing or direct access to the sea through the skirts for more sporting activities - whatever your desires throughout the day, you will find your place on the 46 Open.

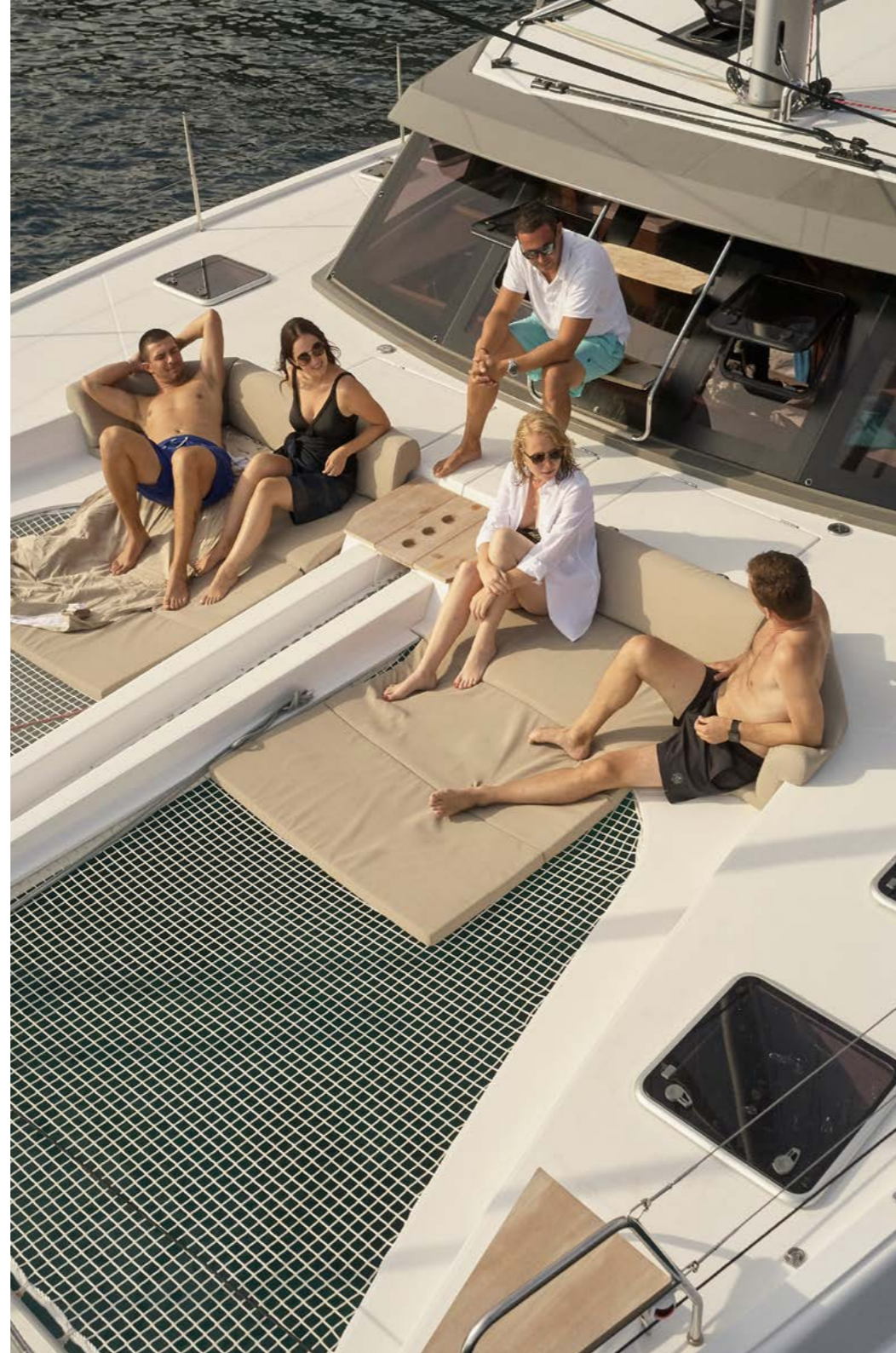

# LIFESTYLE

STYLE.... AT ANY POINT OF SAIL!

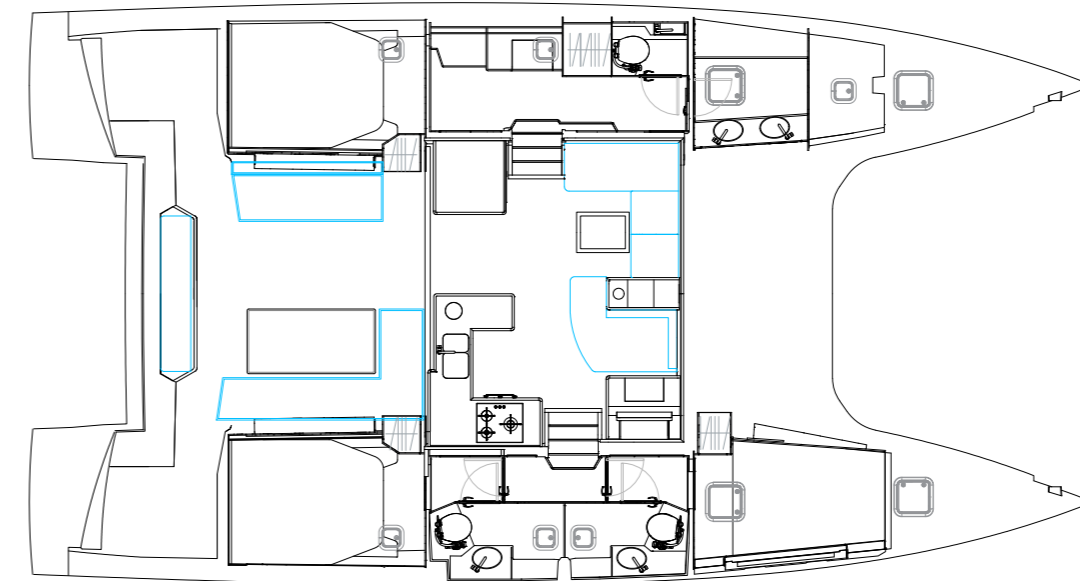

3 cabins

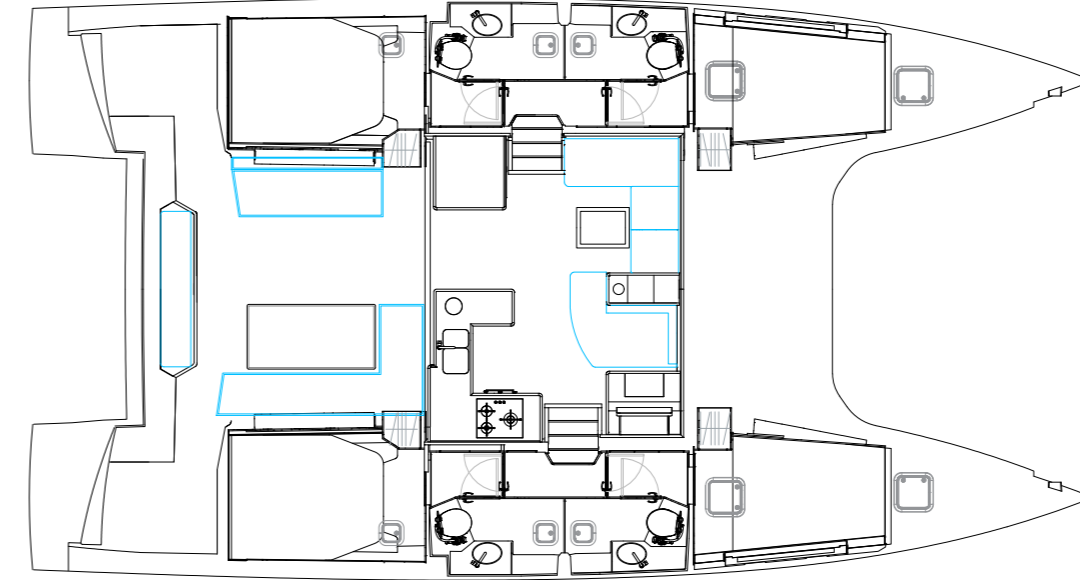

4 cabins

## TECHNICAL DATA

Overall Length	13,79 m / 45'3"
Waterline length	13,71 m / 45'0"
Beam overall	7,54 m / 24'9"
Draft	1,45 m / 4'9"
Unloaded weight (approx.)	10,8 t / 23 810 lbs
Engine	Diesel, Saildrive
Engine power	2 x 50 hp Volvo Penta
Fuel tank	2 x 300 L / 2 x 79 us gal
Fresh Water tank	2 x 300 L / 2 x 79 us gal
Cabins - Heads	3 to 4
Berths	6 to 8
Full batten mainsail	76 sqm / 797 sq ft
Self-tacking jib	38 sqm / 409 sq ft
Architect	Marc Lombard



# NAUTITECH

MAKE  
EXCELLENCY  
YOUR STANDARD

## NAUTITECH CATAMARANS: THE PERFECT BALANCE BETWEEN PERFORMANCE AND COMFORT

My relationship with NAUTITECH CATAMARANS, started in 2009 with the design of the Nautitech 54'. The brief was to create the perfect balance between performance and comfort, for private customers who are keen sailors but want the comforts of modern living too. We also wanted to appeal to sailors who charter a yacht, but do not want it to just be a floating caravan. What I mean by «performance» is genuine sensations at the helm, good top speed when conditions are favourable, and more specifically, high average speed upwind and downwind, without forgetting the important aspect of the time spent motoring, which is frequent with long-distance cruising. And all this without ever having to worry about safety in family navigation conditions. On deck everything is designed to be simple and reliable, easy to be manoeuvred by a reduced crew.

**Marc LOMBARD**  
Naval Architect

---

## A LONG-TERM VISION PROMOTING EXCELLENCY

Running a successful shipyard is a dream come true for the team behind NAUTITECH CATAMARANS. Passion for the sea and shipbuilding is shared throughout every department, and this passion is a fundamental foundation for our company. We believe that navigation must be at the heart of a multihull's DNA. While the current market trend increasingly promotes the catamaran experience as a static one, we design boats that are remarkable when stationary and when blue water cruising. Our customers expect us to be able to sail by maximizing their experience on the water as well as the sensations felt. It is therefore imperative for us to project the future of our catamarans in solutions combining ease of use, comfort in navigation, performance, safety in all wind conditions.

**Gildas LE MASSON**  
CEO



## THE BRAND

It is in Rochefort sur Mer, the very cradle of shipbuilding and naval architecture and birthplace of Pierre Loti, that NAUTITECH CATAMARANS has anchored its activity of construction of luxury catamarans. Anyone familiar with the world of multihulls can quickly appreciate the innovative nature of NAUTITECH CATAMARANS, the first manufacturer to understand and define the very spirit of a catamaran. Nautitech were also the first to propose the concept of open living onboard, that combines the saloon and cockpit into one spacious, functional living area. Understanding how important sensations at the helm are to their customers, NAUTITECH CATAMARANS places equal emphasis on sailing ability and comfort.





[www.nautitechcatamarans.com](http://www.nautitechcatamarans.com)