

LOA: 13.44 M / 44' 11"

Aquila 44Y Specifications

Length overall w/ swim platform & protection platform	13.44 M / 44' 11"
Beam overall	6.56 M / 21' 6"
Height above waterline w/ hard top	5.70 M / 18' 8"
Draft without sacrificial skegs	1.0 M / 3' 3"
Draft with sacrificial skegs	1.16 M / 3' 10"
Light displacement	15,900 KG / 35,053 LB
Fully loaded displacement	22,000 KG / 48,500 LB
Fuel tank	1,120 L / 295 GAL
Water tank	780 L / 206 GAL
Holding tank	240 L / 63 GAL
CE certification	A:12, B:12, C:14, D:21
Sleeps (up to)	8
Max passengers	21
Cabins	3
Heads	3
Showers	4

Propulsion

Standard **2X D4 230 HP Volvo Penta Inboard V-Drive**

Optional **2X D4 320 HP Volvo Penta Inboard V-Drive**

Construction

Hull and deck material	Resin infused vinyl ester throughout
Bulkhead and reinforcing	Resin infused vinyl ester throughout
Core materials (vary in density)	PVC
Gel coat of hull	NPG
Bulkheads	Water tight fore and aft
Bulbous Bows	Molded and attached; breakaway safety
Hull and deck windows	Tempered glass meeting ISO standards
Flybridge structure	Custom built composite structure



MAIN DECK

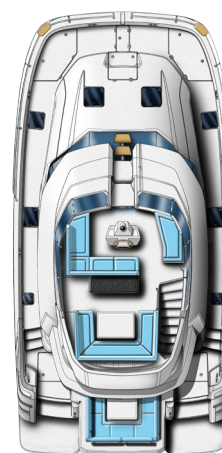

FLYBRIDGE

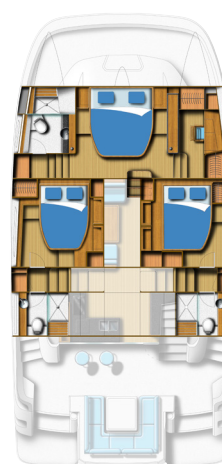

CABINS

Standard Features

An exceptional performing and seaworthy hull shape providing first in class stability and comfort
 Expansive outdoor living and entertaining spaces along with luxurious interior styling and amenities
 Plenty of shade on flybridge via fiberglass hardtop with 316 polished stainless steel supports
 Integrated bar area connecting social areas between aft cockpit and salon/galley
 Comfortable seating throughout for up to 21 people onboard
 Direct bow access from central steps leading from flybridge to bow area
 FUSION multi-zone audio system with eight (8) Fusion speakers and Bluetooth connectivity
 Premium comforts provided for three double berth cabins each with their individual walk in toilet with separate shower

Interior Layout

Three (3) cabins with double berths including private head with walk in shower and fresh water electric toilet
 Large salon area with comfortable U-shaped seating
 Large galley area with common household amenities

Hull and Deck Features

Opening deck hatches carefully positioned to enhance ventilation in cabins (8 total)
 Opening portlights installed in hull side windows and forward salon windows (8 total)
 Custom built PVC rubrail with 316 stainless steel insert offering all around protection
 Custom solid deck railings in 316 stainless steel
 Comfortable & protected bow seats integrated into deck railing (2 total)
 Mooring cleats in solid 316 polished stainless steel thru bolted (10 total)
 Deck fill plates in 316 stainless steel (2 x water; 2 x fuel; 3 x waste)
 Stainless steel bow roller for secondary anchor
 Anchor locker with 1500 watt windlass including handheld remote control with chain lock
 Primary 55 lb. Delta anchor with 150 ft. 3/8" chain with shackles and bridle system
 Secondary 45 lb. Danforth anchor with 200 ft. 3/4" rope on roll
 Well placed ergonomic handrails in 316 stainless steel ensuring secure movement onboard
 Forward access steps from flybridge to bow with 316 polished stainless steel support structure
 Ergonomic transom steps for easy boarding and comfortable lounging off stern
 LED navigation lights, running lights and anchoring light
 Engine ventilation intakes with FRP cowling cover
 Lay flat stainless steel swim ladder
 Large starboard and port bow lockers with easy lift gas hinges for fender or gear storage
 Self draining storage locker in aft cockpit floor
 Aft cockpit, flybridge and side decks all self draining
 Aft cockpit bar area with two (2) stainless steel bar stools
 Engine access lockers with easy lift gas hinge allowing easy access to engine room
 Aft cockpit with expansive hinging window and door opening to galley
 Aft cockpit seating with U-shaped settee with integrated cup holders, built in cooler under seat and lowering cockpit table
 LED deck courtesy lights located at transom, cockpit and flybridge
 Large spacious foredeck for sunbathing

Flybridge

Expansive FRP hard top with radar arch and stainless steel supports
 Access to flybridge from aft stairway and forward bow steps
 Main access from aft cockpit via integrated molded steps
 Ergonomic positioned handrail for safe access from aft cockpit
 Forward flybridge access via center forward bow steps with built in stainless steel handrail for safety
 Flybridge guardrails with acrylic wind protection inserts
 Electronic engine double lever throttle and gearshift control
 Hydraulic steering with variable position steering wheel
 Volvo Penta 7" color display at helm
 Helm station in dark grey non glare UV protection finish
 Helm station storage canvas cover
 Compass at helm station
 Four (4) Fusion marine speakers mounted in hard top ceiling with remote mounted at helm
 Dark acrylic windscreen with 316 stainless steel handrail support to deflect wind glare
 Spacious and comfortable upholstered helm seat and backrest for three (3) people
 Comfortable port side seating adjacent to helm station
 Flybridge table with fold down extensions comfortably seating six (6) people
 Upholstered flybridge cushions with backrests
 Wet bar behind helm station incorporating Corian work surface and sink with hot/cold water faucet
 Integrated hinged fiberglass cover for wet bar area
 Large storage area under wet bar with two (2) access doors
 Dedicated life raft storage under aft seat
 Lifejacket and safety gear storage under flybridge seats
 Cup holders located in various areas around flybridge (7 total)
 Dedicated electrical switch panel for overhead LED lighting and flybridge electrical items including waterproof AC outlet

Engine Room

Custom designed underwater engine exhaust to reduce engine emission noise
 Automatic fire suppression heat activated system with alarm monitors at helm station
 Electronic start/stop switches at helm station with E-Key protection
 Engine room with 50mm flame retardent polyurethane foam covered metalized polyester film insulation
 Engine support frame built in 316 stainless steel
 Engine room lighting
 Automatic bilge pump in each engine room with warning light at helm and nav station
 Excellent all around engine and systems access for ease of maintenance
 Hydraulic steering cylinders (2 total)

Underwater Gear

Engine V-drive transmission for compact efficiency
 Propeller tunnels for reduced draft and maximum efficiency
 Four (4) blade bronze propellers
 Machined stainless steel propeller shafts with rope cutter installed on each shaft
 Rudders and tiller arm in 316 stainless steel with FRP tube
 Shut off valves on all salt water intakes in engine rooms
 Sea water strainers with transparent lid
 Watertight self aligning dripless shaft seal with 316 stainless steel housing
 Extended bronze P-bracket for maximum propeller protection
 Sacrificial skeg forward of drive for added running gear protection
 Black antifouling paint on hull surface at and below waterline

Technical Features

Bilge pump warning lights at helm and navigation station
 Instrument panels including 7" Volvo Penta engine display at helm
 Hydraulic steering system with tilt helm steering wheel
 Custom Aquila stainless steel steering wheel

Salon Area

Excellent all around visibility from salon seating
 Shatter-proof windows with external overhangs offering excellent visibility and reduced direct sunlight
 Tempered glass hinged window via tempered glass door to cockpit offers excellent ventilation and through flow
 Opening port lights in forward salon windows provide excellent ventilation (4 total)
 Custom blinds fitted on salon outboard windows
 Overhead LED ceiling lights, LED mood lighting and LED courtesy lighting
 Panel ceilings with decorative solid wood trim and LED accent lighting
 Cabinets and counter top on starboard side
 U-shaped salon lounge settee around salon table with seating up to six (6) people
 Salon table which has ability to convert into comfortable single bed
 Large shelves behind settees
 Upholstered cushions
 Fusion speakers (2 total)
 Vertical 316 stainless steel handrail in salon
 Synthetic wear resistant flooring offering maintenance free natural wood look

Galley Area

Induction two burner electrical cooktop
 Convection microwave
 Two drawer front access refrigerator/freezer offering easy access and efficient packing
 Double stainless steel sink with Corian worktop cover and single lever variable temperature faucet
 Storage cupboards & drawers offering ample storage for all galley accessories
 Deep dish drying rack with Corian worktop cover
 Durable stain resistant Corian countertop
 Ample storage lockers on starboard side under Corian worktop surface
 Tilt out garbage bin
 Dedicated blender or coffee maker area
 Overhead LED ceiling lights as well as mood lighting
 Synthetic wear resistant flooring offering maintenance free natural wood look

Stateroom Areas

Large windows throughout offering excellent views
 Dedicated hanging lockers
 Ample storage lockers including storage located underneath beds
 Custom blinds fitted on cabin hull windows
 Concealed shade blind and insect screen on opening deck hatch where installed
 Overhead LED ceiling lighting and floor courtesy lighting
 Overhead LED reading lights
 Island style beds in all staterooms
 Large desk area with ample storage located in forward master cabin on starboard side
 Memory foam mattresses
 Synthetic wear resistant flooring offering maintenance free natural wood look
 Cabin doors offering privacy
 Large master stateroom mattress (71"W x 79" L / 180cm x 200cm)
 Large guest cabin mattress sizes (59"W x 79" L / 150cm x 200cm)

Heads and Separate Shower Stalls

Quiet electric push button control fresh water flush toilets with large bowl
 Private door leading into cabin
 Opening deck hatch offering ample ventilation
 Opening port light in large window
 Stylish round wash basin with single lever variable temperature faucet
 Corian countertop surrounding wash basin
 Custom wood blinds
 Vanity lockers with mirrors
 Synthetic wear resistant flooring offering maintenance free natural wood look
 Separate shower stall with seat and flexible shower faucet
 Acrylic door separating shower from the rest of the bathroom
 Automatic shower & sink drain via dedicated sealed sump box
 Overhead LED lighting
 Toilet roll holder located in sink locker

Navigation Area

AC/DC electrical panel with circuit breakers and transfer switches for all electrical systems
 Dedicated service panel for optional generator, desalinator and inverter control
 Dedicated electronics display panel offering easy access and visibility to electronic systems
 FUSION multi-zone audio system with eight (8) Fusion sSpeakers and Bluetooth connectivity
 Electronic panel displaying navigation lights and bilge pump warning lights and manual switches
 Light switch panel controlling all salon, galley and aft cockpit lighting
 Remote battery switches for all onboard batteries

Water and Bilge System

Fresh water pressure pumps with accumulator tank offering equal water pressure throughout
 Dockside fresh water supply connection with pressure reducer
 Two (2) hot water cylinders (16 gal. / 60 L.) powered by engine heat exchanges and AC power
 Two (2) connected water tanks (103 gal. / 390 L.)
 Variable temperature cockpit shower
 Water tank level gauges located on service panel
 Four (4) automatic 12-volt bilge pumps

Water System

Grey water from showers and sinks collected in three (3) sealed sump box's with auto discharge overboard
 Three (3) black water holding tanks (21 gal. / 80 L.) discharged via deck pump out or electric overboard pumps

Electrical System

Inverter/Charger (12/110v 5000 200VA OR 12/230v 5000 200VA) - voltage dependent of boats destination
 Four (4) house Batteries in dedicated battery locker (200amp)
 Two (2) dedicated engine start batteries (200amp)
 AC power supplied by two (2) shore power cables (50amp 125/250v)
 Dedicated circuit breaker switches for all high load components
 Galvanic isolator protection system
 Two (2) shore power supply plugs (50amp)

Fuel System

Diesel fuel system with Racor water separation filters
 Dedicated fuel tank for each engine (147 gal. / 560 L.)
 Fuel filters for each engine
 Aluminum fuel tanks with safety shut off valves and level monitors at helm station

Safety

Tempered glass escape hatches located under cabin stairs with emergency escape hammer
 Automatic fire suppression heat activated system with alarm monitors at helm station
 Emergency steering tiller in 316 stainless steel
 Mooring kit (6 x fenders; 6 x mooring ropes)