

FOR SALE - SPECIFICATIONS

# SILVERCAT SC22M

# FRASER



## THE EXPERT'S VIEW

*The ultimate boating adventure with the all aluminium SilverCat built by Silver Yachts. This sleek and sturdy vessel is designed Espen Oeino for comfortable cruising, impressive speed and unmatched stability on the water. Boasting exceptional durability, low maintenance, and eco-friendliness.*

## CONTACT

EUGENIO CANNARSA

M: +61 (0) 424 780 854

[EUGENIO.CANNARSA@FRASERYACHTS.COM](mailto:EUGENIO.CANNARSA@FRASERYACHTS.COM)

PETER REDFORD

M: +61 (0) 419 794 777

[PETER.REDFORD@FRASERYACHTS.COM](mailto:PETER.REDFORD@FRASERYACHTS.COM)

## 22.00 M / 72'02"

## SPECIFICATION

BUILDER	SILVER YACHTS
BUILT / REFIT	2024
BEAM (M/FT)	10.80 M / 35'05"
DRAFT (M/FT)	1.20 M / 3'11"
HULL MATERIAL	ALUMINIUM
ENGINES	TWIN VOLVO D13-1000(L6)
SPEED	17 KNOTS / 20 MAX
EXTERIOR DESIGNER	ESPEN OEINO
INTERIOR DESIGNER	TILLBERG DESIGN OF SWEDEN
GUEST / STATEROOMS	6 / 3
CREW	2

PRICE

USD 5,140,000

Yachts offered are subject to availability. The particulars are believed to be correct but are not guaranteed and may not be used for contractual purposes. Specification provided for information only.

## SILVERCAT SC22M



## MAIN CHARACTERISTICS

Name:	SILVERCAT SC22M	
Type:	Catamaran	
Builder:	Silver Yachts	
Year:	2024	
Hull No:	881	
Yacht Model:	SilverCat SC22M	
LOA (M/FT):	22.00 M	72'02"
LWL (M/FT):	21.28 M	69'10"
Length COR:	22.00 M	72'02"
Beam Overall (M/FT):	10.80 M	35'05"
Draft (Full Load) (M/FT):	1.20 M	3'11"
Hull Material:	Aluminium	
Decks:	3	
Naval Architect:	Silver Yachts	
Exterior Designer:	ESPEN OEINO	
Interior Designer:	TILLBERG DESIGN OF SWEDEN	
Main Engines:	Twin Volvo D13-1000(L6) 735KW@2400rpm 1000MHP	
Speeds:	20 kts Max 17 kts Cruising	
Range:	1,600 nm @ 10 kn	
Guest Accommodation:	6 guests in 3 staterooms Optional 4 cabins and 8 guests	
Crew Accommodation:	2	

# SILVERCAT SC22M



## KEY FEATURES

- ◆ Luxury 72ft/22m Power Catamaran
- ◆ Up To 20 kts Max Speed
- ◆ Dining And Lounge Space 65 square meters
- ◆ Main Deck Space 91 square meters
- ◆ 3 Double Bed Cabins
- ◆ 2 Crew

## CLASSIFICATION

Classification: Member of IACS  
 IACS Society: Built to CE Cat.B.

## ACCOMMODATIONS

### LOWER DECK:

Lower Deck Guest Cabin : 48.5 m<sup>2</sup> - 12 m<sup>2</sup> x 3 Double Bed with Ensuite

### MAIN DECK:

Main Deck Dining Lounge : 65.5 m<sup>2</sup>

Main Deck – Clear Deck space : 91.0 m<sup>2</sup>

### SUN DECK:

Sun Deck – Clear Deck space : 71.0 m<sup>2</sup>

### CREW ACCOMODATION:

Lower Deck Crew Cabin: 8.6 m<sup>2</sup> - 8.6 m<sup>2</sup> x 1 with 2 Singles with Ensuite

## CONSTRUCTION

Hull Material: Aluminium  
 Decks Material: Teak  
 Motor Hull Type: Catamaran  
 Number of Decks: 3

## CAPACITIES

Fuel Capacity:	10,000	Litres	2,642	Gallons
Fresh Water Capacity:	1,500	Litres	396	Gallons
Grey Water:	800	Litres	211	Gallons

# SILVERCAT SC22M



## MAIN MACHINERY

Main Engines:	Twin Volvo D13-1000(L6) 735KW@2400rpm 1000MHP
Gear Boxes:	Two (2) - ZF 400 IV
Propellers:	Two (2) – Cu3 FPP

## GENERATORS & ELECTRICITY

Output/Electricity:	Single Phase 230v 50hz, 24v DC
Generators:	KOHLER

## AUXILIARY MACHINERY

Bow Thruster:	Twin electric tunnel thrusters, QUICK or similar.
---------------	---

## AC & Ventilation System

Air Conditioning:	Chiller water-cooled type to serve main deck and lower deck cabins, CLIMMA or similar.
-------------------	--

## NAVIGATION SYSTEMS

Navigation Bridge:	GARMIN or similar, to meet Flag requirement
--------------------	---

## SAFETY, SECURITY, & FIRE FIGHTING EQUIPMENT

CCTV:	CCTV security system (6 cameras).
Fire Alarm:	Fire detection & alarm system.

## ENTERTAINMENT, AUDIO/VISUAL AND IT SYSTEMS

Video Equipment:	Antenna for terrestrial TV and cabling to all TV's. Network cabling capable of streaming video to all TV's & iPad
Audio Equipment:	Antenna for terrestrial TV and cabling to all TV's
Main Salon:	Home cinema External speaker system capable of multi-zone audio control for music streaming will be provided in main deck lounge area
Master Stateroom:	Home Cinema and soundbar in Owner Cabin
WIFI:	Wi-Fi internet access throughout the vessel
Other Equipment:	Winch: One electric anchor winch in the foredeck, QUICK or similar

## TENDERS & TOYS

Tenders:	Williams Dieseljet
----------	--------------------

# SILVERCAT SC22M



## GENERAL ARRANGEMENT

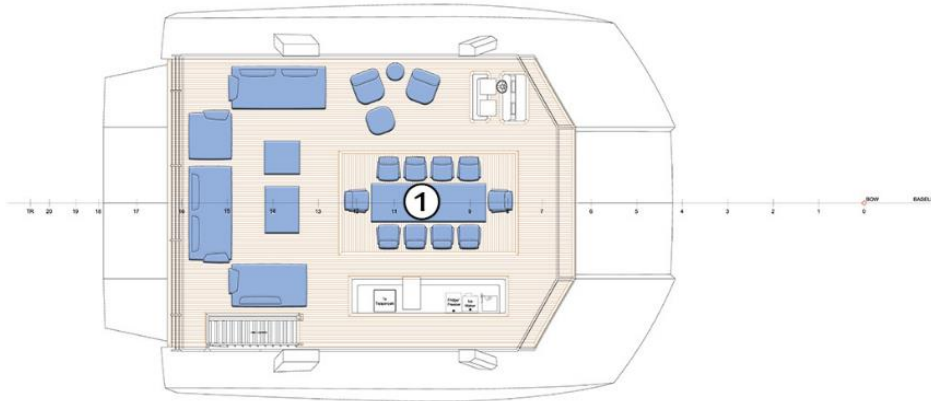

SUN DECK

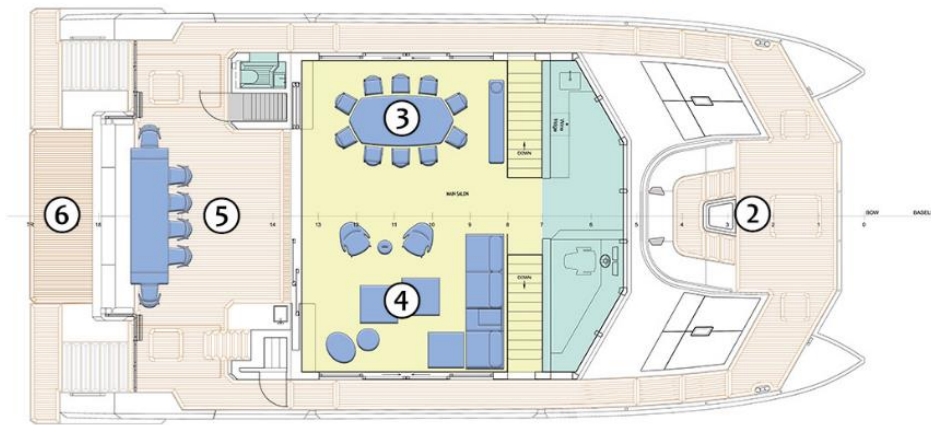

MAIN DECK

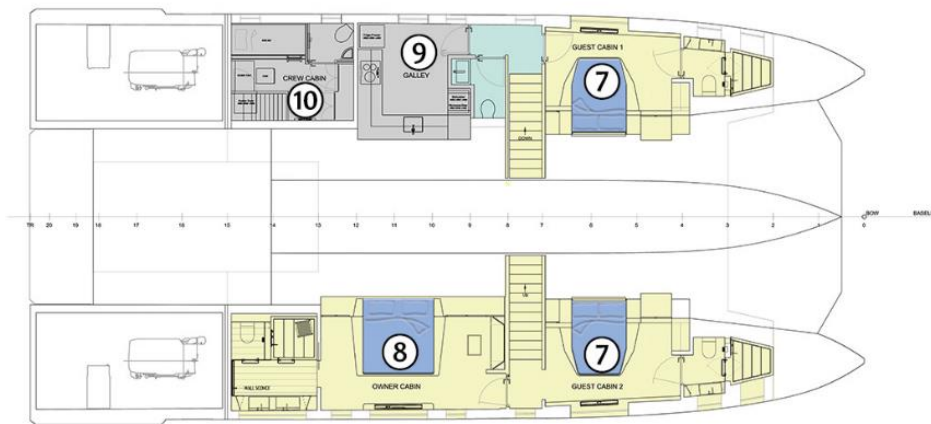

LOWER DECK

Yachts offered are subject to availability. The particulars are believed to be correct but are not guaranteed and may not be used for contractual purposes. Specification provided for information only.