

5	6	7	8
			REVISIONS
ZONE	REV	DESCRIPTION	DATE

# PROFILE

### CONSTRUCTION NOTES:

#### PLATE SIZES:

- BOTTOM - 5PL.
- SIDES - 5PL.
- DECK - 4PL.
- FRAMES - 5PL. RINGS
- TRANSOM - 10PL.

TOTAL ALLOY ESTIMATE: 4000kg

NOTES: 1. FULL SIZE PATTERNS ARE PROVIDED FOR ALL MAIN PLATE & FRAMING COMPONENTS.

GLAZING: 8mm ARMOUR GLASS THROUGHOUT  
 MOTOR: 2 X 300+ HP SPP / LEG OR JET

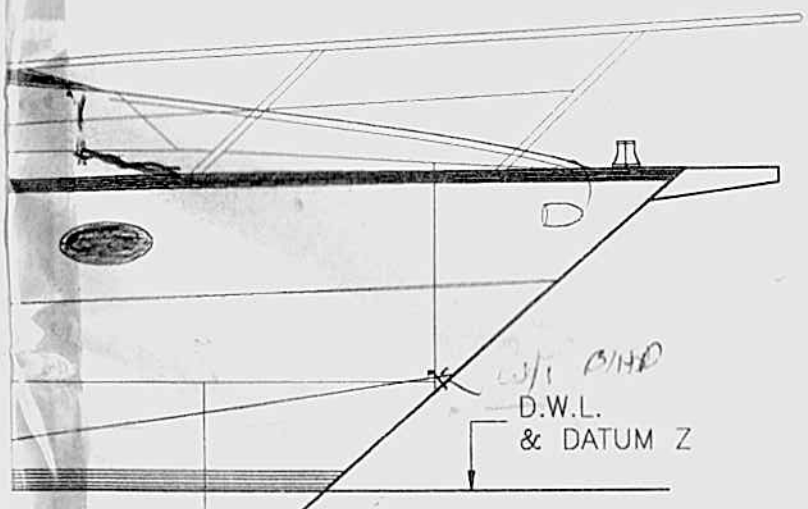

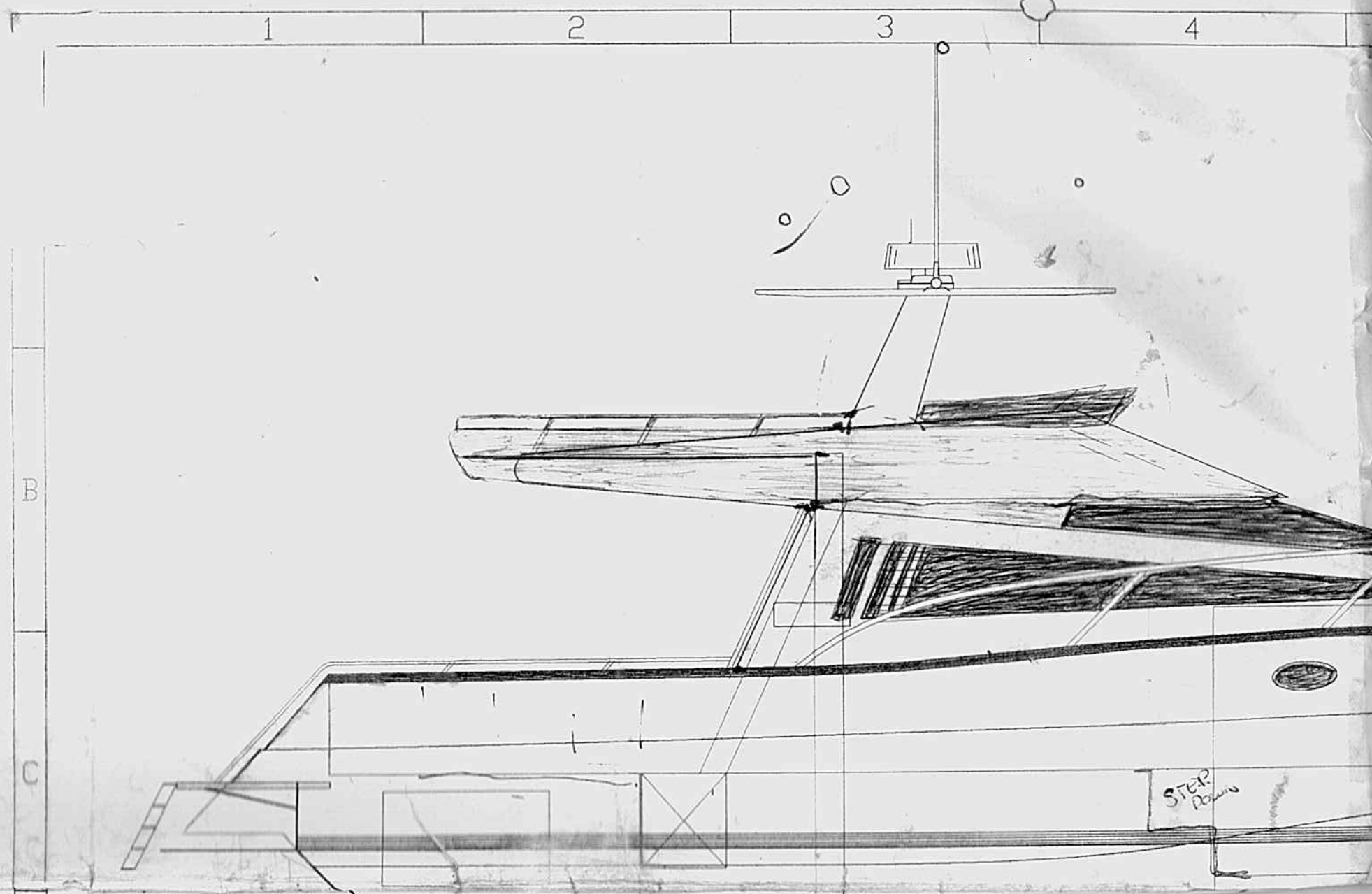

STEP  
Down

WT 3/4" (1)

DATUM X

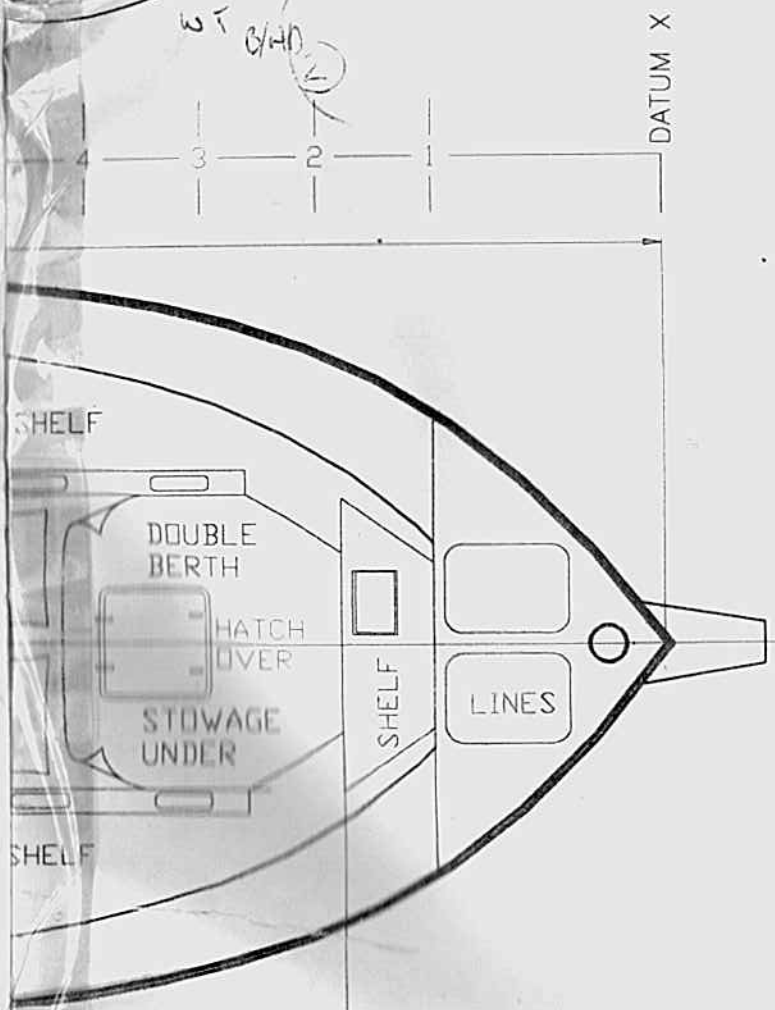

PLAN

WLL 10M  
WLB 3.4M

C/L

UNLESS OTHERWISE SPECIFIED  
ALL DIMENSIONS  
ARE IN MILLIMETRES  
DO NOT SCALE DRAWING

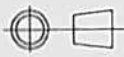

MATERIAL: AS NOTED

DAVID JACKMAN  
BOAT DESIGN

VESSEL  
39' FAST CRUISER

TITLE  
GENERAL ARRANGEMENT

DRAWN

DATE

SIZE

VESSEL NO.

DWG NO.

REV

DESIGN

D.A.J.

SCALE 1:40

CLIENT RAIDER

SHEET 1 OF 1

2000  
3000

5

6

7

8

0

D

E

F

0

D

E

F

W/T BHD

*W/T BHD*

W/T BHD

T 17 16 15 14 13 12 11 10 9 8 7 6

11970

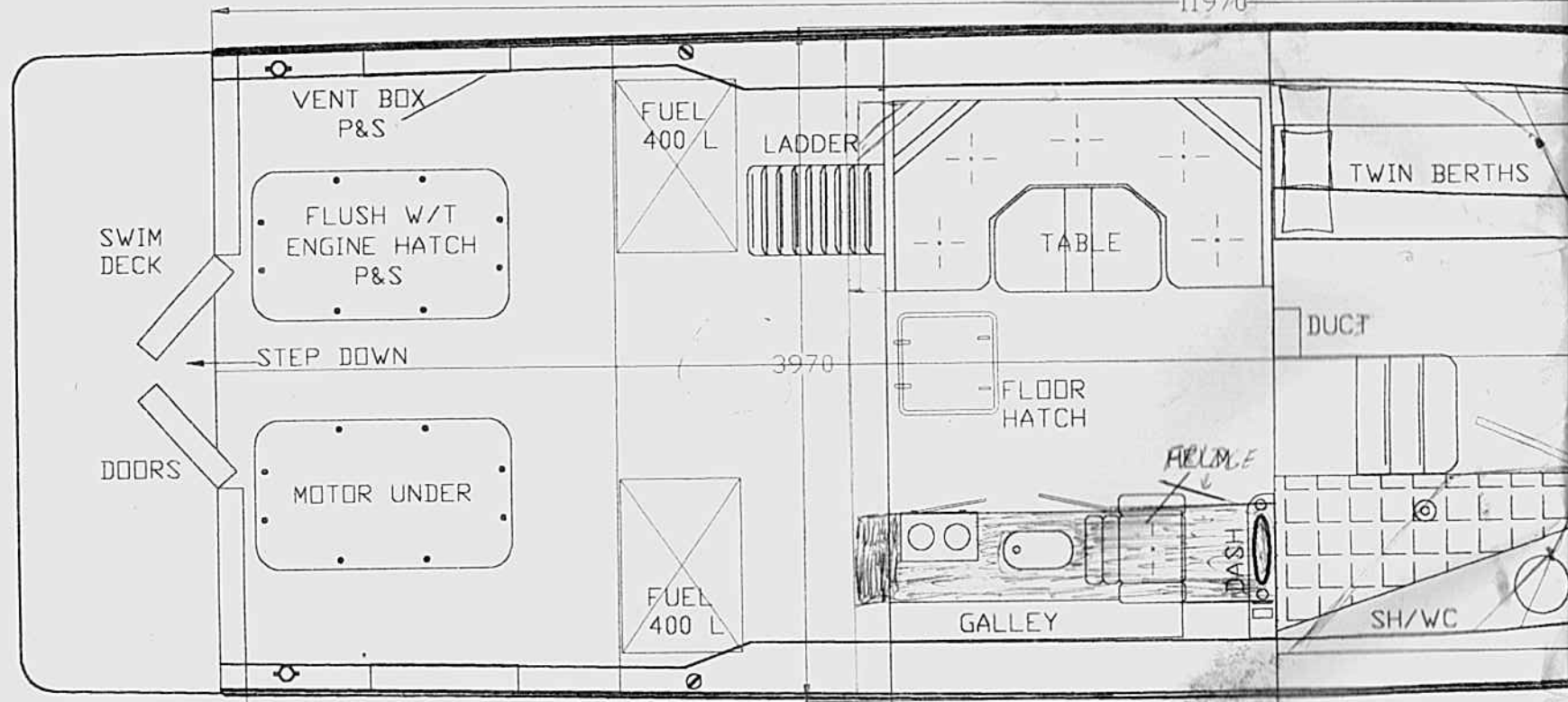

3970

3860

2300

1900

**4500**

**3000**

**2250**

1

2

3

4