

Runaway Bay Pontoon Boats

Made by Highgate Engineers a division of Holmwood Highgate (Aust)

A.B.N. 70055046038

155 Ford Road, Burbank, Qld. 4156

PO BOX 3753, Loganholme, Qld 4129

Email: craig@runawaybaypontoonboats.com

Office: 07 3440 9000

Fax: 07 3440 0693

Web: www.runawaybaypontoonboats.com

Confidential - Page 1 of 7

Ref; 0728-22

REV D Additions & Notes added

27-02-23

New 26ft pontoon boat package deal.

Gold Coast

Dear

Please accept this letter as our official quotation for the supply of our pontoon boat as listed below: -

1 x 26FT (7.9M) Deck size, 8.82 O/A Tri- Hull PONTOON BOAT ONLY AS PER SPECIFICATION ATTACHED:

Mercury motor 250Hp XL

Option A, Fibre Glass, Total cost price custom built as a Package Deal: sail away.

14 persons for 26ft, custom styled and built, based on show boat model 2022 as seen but by supplied plan layout.

***Quote is valid to end till 14th Oct 2022, as one off deal.**

***Abbreviations *TBD; to be decided. *NC no charge, TBC; to be confirmed.**

NOTES:

Canopies should be folded, socked and secured during road transit. It is ultimately up to the vessel operator to determine if the canopy and/or side curtains if fitted, should be up or stored away when vessel is underway. Runaway Bay Pontoon Boats are not responsible for damage to the canopy or side curtains while in use in windy or other adverse weather conditions. Please note as with all products of this type it is not recommended to be left up in excessive wind unattended.

ESCALATION:

We have used our best endeavour to submit a competitive price based on the costs at the time of this quotation. However, due to the current economic climate of erratic price changes and labour shortages, the above pricing will be subject to rise and fall from the date of this quotation. An updated price will be given at the time of ordering and again at the commencement of the build.

PAYMENT:

DELIVERY: Free delivery with hand over on the GC or too your nearest ramp, based on legal 26ft Long.

WARRANTY:

Design and manufactured items by RBPB 3 years.
Bought in items, suppliers' standard warranty terms.

We thank you for the opportunity to submit our offer and look forward to receipt of your favourable reply.



Yours faithfully
Craig Winch Mobile

Runaway Bay Pontoon Boats

Made by Highgate Engineers a division of Holmwood Highgate (Aust)
Confidential - Page 2 of 7

SPECIFICATION: All Standard inclusions on RBPB

LOGS – TRI HULL:

3 x 660mm 26" (approx.) diameter x 2.5mm marine grade aluminium fitted with extruded top mountings for floor frame.

Each log has sealed chambers to assist buoyancy in case of accidental piercing of the log.

Chine bar is stitch welded to the lower side of each log.

Anode mountings are fitted to the stern of each log below the waterline.

Under deck sheeting between tubes. Tri hulls only.

FUEL TANK – Tri-hull:

180 litres approximately inbuilt to centre log at stern. Shear plates made from aluminium tread plate are fitted to each side of this pod to spread the loads in the event of your boat running onto sandbanks. Fuel gauge and fittings are in accordance to outboard suppliers' recommendations.

DECK:

19mm fibre composite sheets, sealed and bolted to supports with large headed stainless-steel bolts & nylon nuts.

80mm x 40mm x 4mm structural marine grade aluminium channel for the support of fibre composite floor. Sikka flex is applied between the flooring and channel supports.

Deck perimeter is a heavy duty 6000 series powder coated aluminium extruded channel, **colour White**. Floor covering is a marine grade Woven vinyl flooring **Grey Teak** or similar colour as on standard boat. Glued as per manufacturers recommendations. All as seen!

WALLS: OPTION A:

Fibreglass sheets is fitted within the extruded anodised aluminium framework.

Sheet is in white interior, the exterior colour **Gloss White as seen with single bar work** Silver graphics as per white show boat.

Doors, lift-up type resting on a 'U' cradle when closed. **Number of doors 3**, with Front & Rear only in polycarbonate but subject based on final boat layout.

Note: Walls as per described above and plans,

SEATING:

Portside bow lounge Sports series radius bench seat with kickboard

Starboard bow lounge Sports series radius bench seat with kickboard

Sports series lounge arm with lift up backrest, **extra extension lounge before**

console.

Portside stern lounge Sports series longer bench seat with kickboard, as per sketch

Sports series lounge arm with lift up backrest, as per- sketch

Helm seat

Sports series reclining seat with adjustable head rest and sliding swivel pedestal

Lounge colours

Executive sport being light grey with white stitching, charcoal insert centres as seen

at factory supplied.

All as per plan and seen on the show boat.

Sorry pull out bins are no longer available.

(As seen, as per plan provided example only)

Runaway Bay Pontoon Boats

Made by Highgate Engineers a division of Holmwood Highgate (Aust)
Confidential - Page 3 of 7



CONSOLE:

New Style 2022 model Fibreglass with new look dash, Italian sports steering wheel, fitted with DC outlet, deluxe rocker style panel switches and side door for access to the batteries, isolation switch and wiring loom, double USB ports in rocker switch. **colour Grey.**

SOUND SYSTEM:

Fusion Marine RA70, blue tooth, with 4 x 6" LED RGB FR602 marine grade speakers & USB socket. Colour changing speakers with remote.

ELECTRICAL:

Wiring comprises 16-amp twin core twin sheathed tinned multi-strand wire, 170 amp Red & Black single core battery cables and 51-amp single core tinned wire, dual battery boxes.

3 position VSR switch.

Port & starboard navigation lights

2 Docking lights.

1 Anchor light

1 x 12V power socket on console front.

1 x Lowrance 7" Elite touch screen as fitted and transducer with install.

Tube strip lights with colour change, controlled by phone.

1 x silicone Blue LED strip light sewn into rear bimini canvas.

1 x battery Pro – Sports charger 20amp model

1 x double USB port on bench wall PS

1 x 12V socket sink side bench wall.

ANCHOR BOX:

Anchor housing in front wall on Port side, with hatch cover and sand anchor, chain and rope installed.

HORN:

1 off.

FIRE EXTINGUISHER:

1 kg marine approved type.

BIMINI:

Black Ultra Sunbrella.

Socks are supplied to fit over the Biminis when folded back for transit. Two-piece top.

Runaway Bay Pontoon Boats

Made by Highgate Engineers a division of Holmwood Highgate (Aust)
Confidential - Page 4 of 7

CUP HOLDERS:

1 off in console blue LED
3 off portable type each with 2 cup holders
Additional cup holders can be fitted if required at an additional cost.

DOCKING CLEATS:

4 (1 on each corner)

LADDER – FRONT & REAR:

1 x alloy LillyPad folding step ladder with wider foot steps as requested. **Rear only.**
1 x below under deck as already fitted.(alloy) standard fitment.

SERVING BENCH:

Serving bench with deluxe sink, 40ltr freshwater tank, **drain hose through flooring**, change room curtain below bench top.
12V pump with tap fitted.
Deck shower, bayonet fitting, soft or coil hose with nozzle supplied, fitted on rear deck back wall, Star side.

TOILET:

12V flushing toilet with holding tank, fitted below serving bench, comes with privacy change curtain.

FRIDGE:

Isotherm fridge / freezer, 85ltr Inox S/S fridge, fitted below small black top bench on Portside rear as per plan.

BBQ MOUNT:

BBQ drop hole spigot, front deck corner, ideal for mounting alloy BBQ stand. NC

BBQ STAND:

Custom made BBQ stand to suit Webber Q, black PC finish.

DOCKING & SAFETY GEAR:

3 x inflatable fenders supplied and 2 x docking ropes.
6 x life jackets supplied
2 x docking ropes

TABLE:

Rectangular shape table x 2, with 1 x bayonet floor base, either front or rear lounge areas, matching console colour
Grey, extra base fitting included, 1 x front, 1 x rear

STORAGE COVER:

Boat fitted with a half playpen storage cover, 1 or 2 adjustable poles maybe fitted to assist water run-off, ideal for traveling and storage when not in use, easy portside door access with extra zipper, to be fitted with bungee cord.

Rear deck cover, as mentioned easy clip on/off deck cover to protect against harsh sun helps reduce fade and bleaching on flooring when boat is not in use. **Price TBC approx. \$500.00 ???**

Runaway Bay Pontoon Boats

Made by Highgate Engineers a division of Holmwood Highgate (Aust)
Confidential - Page 5 of 7

REGISTRATION

12 months Boat Marine registration.
Boat name as discussed _____

Mercury 250 hp XL fully fitted, 2 x Smart craft gauges, 2 x M70 marine batteries, top mounted binnical control, S/S prop, water tested. Hyd steering with power pump, fly by wire or DTS. _____

ANTI-FOULING:

Anti-fouling included, done by licensed contractors.

8
7
6
5
4
3
2
1
A
B
C
D
E
F

- EXECUTIVE GREY CHARCOAL**
STARBORD FRONT
- 1 OFF K230-304 30" RADIUS BOW BENCH
 - 1 OFF K230-304 30" STRAIGHT LOUNGE
 - 1 OFF K230-304 28" STRAIGHT LOUNGE
 - 1 OFF K230-304 17" LEFT HAND RECLINER
- PORTSIDE FRONT
- 1 OFF K230-304 30" RADIUS BOW BENCH
 - 1 OFF K230-304 30" STRAIGHT LOUNGE
 - 1 OFF K230-304 28" STRAIGHT LOUNGE
 - 1 OFF K230-304 17" LEFT HAND RECLINER
- AFT PORT SIDE
- 1 OFF K230-304 17" LEFT HAND RECLINER
 - 1 OFF K230-304 28" STRAIGHT LOUNGE
 - 1 OFF K230-304 28" AFT CORNER LOUNGE
- HELIX CHAIR
1 OFF TRL-MOXY RECLINING CHAIR

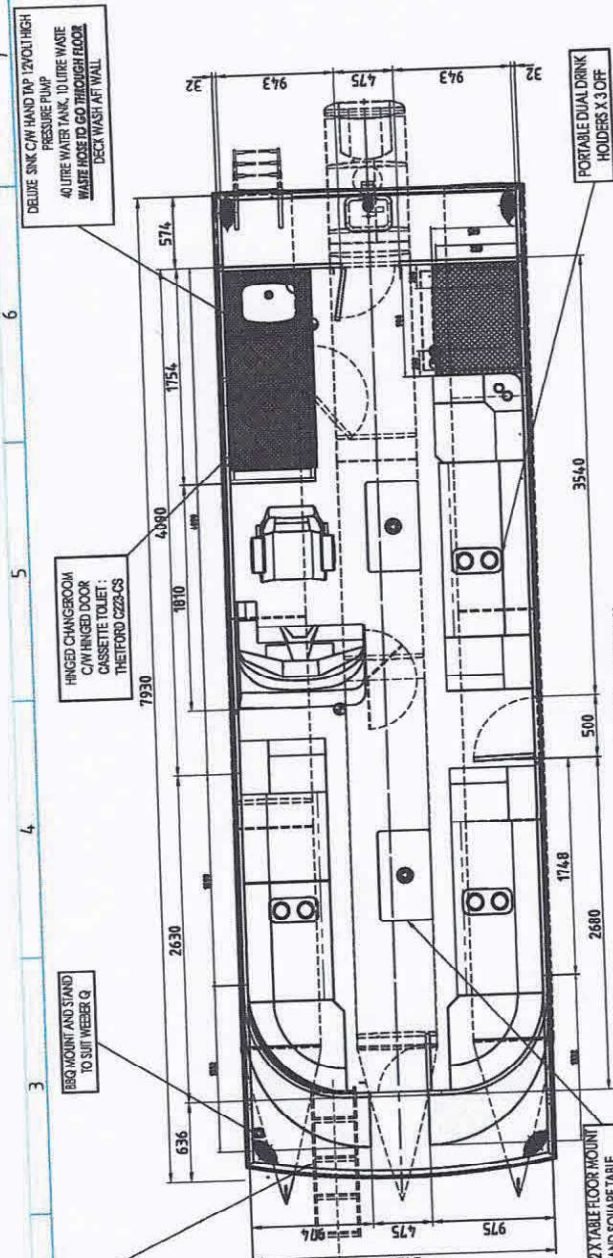

DECK DETAIL
SCALE: FULL SIZE

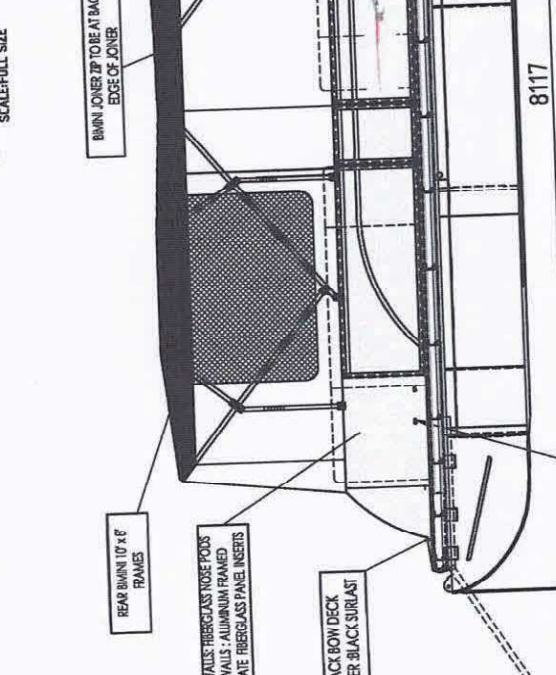
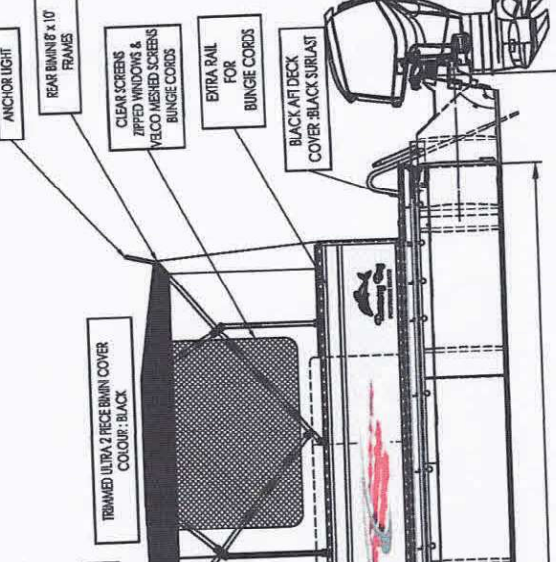
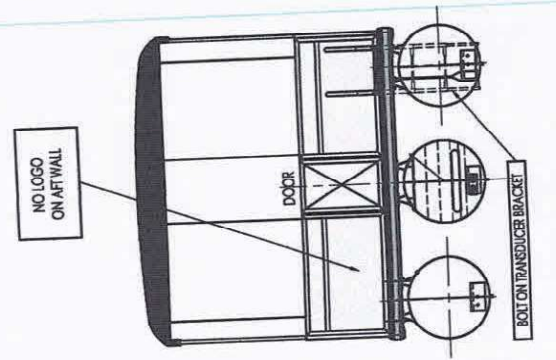

Runaway Bay
PONTON BOATS

GENERAL ARRANGEMENT
8.84 METRE (26 FOOT DECK)
TRI HULL PONTON BOAT

SCALE: 1/4"

REV: A A3

TOLERANCES IF OTHERWISE IS NOT STATED:
LINEAR DIMENSIONS: ± 1mm
ANGULAR DIMENSIONS: ± 1°

ALL DIMS IN mm
DO NOT SCALE
DATE: 18/01/2024
ORIGIN:

DRAWN: S STREET
APPD:

RIGHT RESERVED SCALE: 1/4"

The design as detailed on this drawing is the property of HOLMWOOD HIGHGATE (AUST) (ACN 055 045 038) and/or its associates and must be returned on demand. It is issued on the strict condition that except with our written permission it must not be reproduced, copied or communicated to any third party nor be used for any purpose other than that stated in the particular enquiry, order or contract with which it is issued. The reservation of copyright in this document extends from each data appearing thereon and in respect of the subject matter as it appeared at the relevant date.

FILE: X:\Highgate Engineers\DRAWINGS\HIGHGATE PONTON BOAT\PROPOSAL_PONTON BOAT\A1-A4-PONTON-8.84m.dwg

REVISION	DATE	DESCRIPTION	AUTH

- UNDERDECK LADDER**
- BROW AND STAND TO SUIT WEBBER Q.**
- FLOORING SPECIFICATION:** 18mm COMPOSITE FLOORING FLOORING COLOUR: MARINE VINYL TEAK GREY
- FLOORING COLOUR:** GREY/CHARCOAL
- LOUNGES:** EXECUTIVE - GREY/CHARCOAL
- CONSOLE STORMI GREY**
- FIBREGLASS CONSOLE C/W CARBON FIBRE LOOKDASH STEERING WHEEL, ROCKER SWITCH CONTROL PANEL (BLUE BACK LIGHTS), USB OUTLETS, TWO BATTERIES, ISOLATION SWITCH AND WIRING LOCAL MOTOR CONTROL BINNACLE AND SMART CRAFT DIGITAL GAUGES HYDRINE HYDRAULIC STEERING 2 OFF BLUE LED CLIP HOLDER 12V SOCKET X 1 OFF**
- SOUNDING / GPH: LOWRANCE TT FS**
- STEREO: FUSION MARINE INTO C/W 6.5" BLUE MARINE SPEAKERS**
- LIGHTING:** BLUE SILICON LED LIGHTS IN BMINI FRAMES LED LIGHTS IN LOUNGE SEATS - NIL LOG STRIP LED LIGHTS: RB93 LED ON OUTSIDE LOGS X 8M PREP BENCH SINK STARBORD AFT, DELUXE SINK/PREP BENCH LIFT UP, CASSETTE TOILET: THEIFORD C223-CS 12V X 20AMP SOCKET X 1 OFF IN STORAGE AREA, 12VOLT WATER PUMP 40 LITRE WATER TANK, 10 LITRE WASTE BOTTLE C/W THRU DECK HOLE, DECK WASH: YES
- PREP BENCH PORT AFT:** PREP BENCH NIGHT SKT 12 VOLT X 20 AMP POWER SOCKET 12 VOLT DUAL USB POWER OUTLET 85 LITRE 5/8" STEEL FROGE