



FOR SALE
Sailing Vessel F5
51 ft Catamaran

270,000 USD



After continuously cruising in the South Pacific for 3 years, making upgrades and improvements, SV F5 is ready to be

sold. This Mayotte 47 is ready to be sailed away today for ones new adventure. She is very comfortable under sail and at anchor. At this price point, you will not find a more comfortable sailboat to call home. Captain is willing to deliver or show the vessel in Oceania or SE Asia. As a lifetime Polish registered vessel and company owned, the ownership transfer can be easy, quick, and open to many possibilities.

The **Mayotte 47** is a cruising catamaran known for its spaciousness and comfort, making it a popular choice among sailing enthusiasts. Here are some key details about this model:

Design and Features

Construction: The Mayotte 47 is built using the same hull mold as the Voyage 500, with specific differences in the length of the transoms. This design with an 8 meter beam contributes to its stability and performance on the water and comfort at anchor.

Cabins: The catamaran features four cabins with queen-sized berths, each with en-suite, the single crew cabin has been converted to storage cabinets. This layout is designed for comfort during extended voyages and live a boards.

FOR PHOTOS SEE

https://drive.google.com/drive/folders/13O5msA-Oxr7A_XfRyNSeFXclWMFNjJUW

Living Space: The main salon, galley and cockpit provide one very spacious living space, providing ample room for relaxation, cooking and sailing. The galley is larger than in many homes. An over-sized butcher block countertop separates the galley and the salon, and there is enough floor space for 5 to 6 people to practice yoga in the salon, on the soft flooring, and in the cockpit at the same time.

The combination of gas, induction cook top along with solar oven allows for a variety of cooking options and sustainability. The cockpit area is roomy with a removable table for sailing, custom hardtop supports solar panels, and water catchment. The Victron charging and battery management system provides ample power for instruments, refrigeration and cooking while supported by 1.4kw of solar with wiring and room for additional flexible and hard panels.

Storage and Accessibility: The vessel includes good access to aft engine rooms, which are not part of the living space. It offers plenty of storage options throughout the boat including custom shelving in the aft cabins.

Performance and Condition

Sailing Qualities: The Mayotte 47 is noted for its exceptional sailing qualities, allowing for a balance of speed and comfort, making it suitable for both leisurely cruising and more adventurous sailing. With the oversize rig F5 can be sailed hard to achieve 200 nm + days with a beam or aft wind. F5 will sail well at 40+ degrees.

Refits and Maintenance: During the last 5 years F5 has undergone significant refits to maintain and improve her condition, comfort, safety and performance.

Notable Improvements:

2024,2025

- Engines rebuild one each year.
- additional Victron lithium battery with BMS and solar array additions
- Antifouling
- Sail maintenance and repair
- New portable fridge / Freezer

2023

- Tender upgrade to Ocean Cruising Tender OC350
- Victron battery management system installed
- Victron lithium batteries installed
- upgraded Raymarine navigation and instruments.
- Galley Renovation
- New cockpit sunshade and Sunbrella cushions
- Antal mainsail track reinstalled / reinforced

2022

Forward crossbar was removed for maintenance. New tabs welded for the forestay, and new bushings machined for where the crossbar attaches to the hulls.

2021:

- New Maxwell windlass
- New anti foul
- All new Marelon thruhulls
- New waste water plumbing.

2019/2020

- Standing rigging replaced with New Dyform 1×19 wire and Dyneema
- Isotherm fridge, two drawer
- Running Rigging New
- Sunpower solar panels
- 4 victron controllers

Specifications	
Catamaran Name:	F5 (fka Wild Thing)
Model:	Mayotte 47
Year built:	1993
Builder:	Fred Scholtz Marine, Capetown, South Africa
Designer:	Alex Simonis
Construction:	Hand laid CSM & quadraxial roving with vinyl-ester resin cored with PVC foam for stiffness, strength and insulation. Her keels are low aspect ratio, fin design for lift and enhanced windward performance. There are full-length skegs with elliptical rudders. Deck and superstructure is hand laid multi-directional glass roving molded in one piece and cored with end grain balsa. Deck to hull joint is chemically bonded.

LOA:	14.25 meters (46 feet 9 inches) 15.5m (51 ft) with bow sprit
Beam:	8.3 meters (27 feet 3 inches)
LWL:	13.5m (44 ft 4 inches)
Head room:	1.9m (6 ft 4 inches)
Draft:	1.35 meters (4 feet 5 inches) - when fully loaded 1.65 meters (5 feet 5 inches)
Displacement:	8,160kg (18,000lbs) net tonnage with no equipment
Mast Height:	20.7m (68 ft)
Speed:	6-9 kts cruising speed
Fuel Tanks:	400 liters (105 gallons) in two tanks
Water Tanks:	360 liters (95 gallons) two tanks plus pure drinking water system.
Engines:	2X - Yanmar 3gm30 rebuilt 2024/2025 with Balmar serpentine belt and “belt Buddy” on both engines
Solar:	Victron house bank of 1,100 ah of lithium and Lead acid supported by 1390 watt of SunPower solar.

Sails:	<ul style="list-style-type: none"> * Fully battened Hydranet mainsail * 2x 100% working jib * 110% lighter air jib * Storm jib * 3oz Dacron 200% gennaker. * 1.5oz Asymmetrical spinnaker in dousing sock * 0.75oz Symmetrical spinnaker in dousing sock * All sails in good condition reconditioned by sailmaker in 2024.
Cabins:	4 queen size cabins with ensuite heads
Heads:	3 heads+, 4 showers plus outdoor shower (fourth head is compost)
Galley Location:	Renovated large galley area with 3 fridges

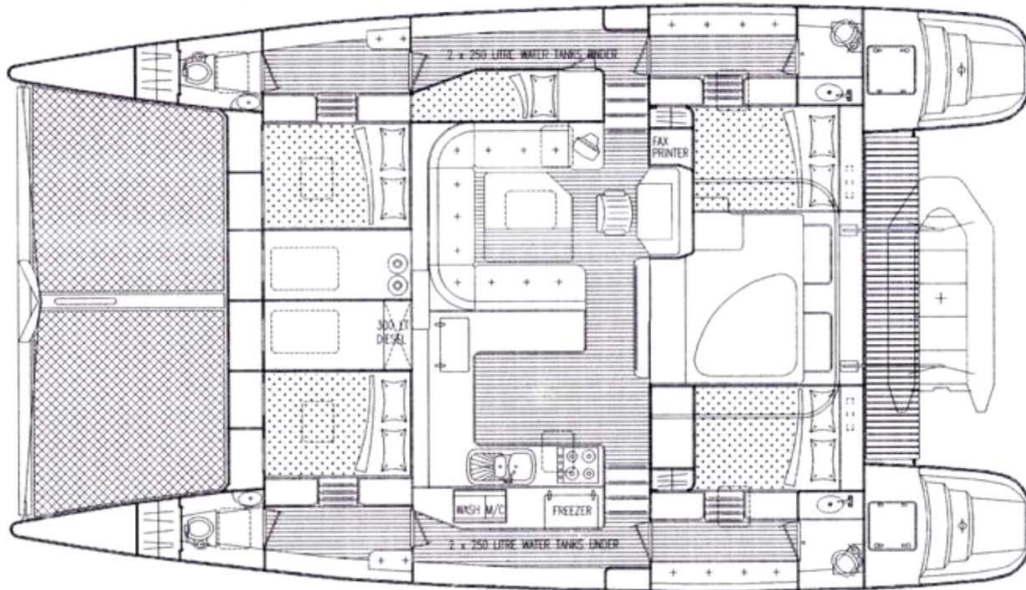

Construction

- Hand laid CSM & quadraxial roving with vinylester resin cored with PVC foam for stiffness, strength and insulation.
- Her keels are low aspect ratio, fin design for lift & enhanced windward performance.
- There are full-length skegs with elliptical rudders.
- Deck & superstructure is hand laid multi-directional glass roving molded in one piece & cored with end grain balsa.
- Deck to hull joint is chemically bonded.

Accommodations

- 4 queen berths
- each cabin has en-suite heads with one having setup for compost head.
- cabins are private & well insulated from sound from the rest of the vessel
- 12v fans in cabins and salon (new 2021)
- 12v reading lights with red/white + USB charger in cabins
- additional battery operated fans in cabins (New 2023)
- Washing machine Splendide 7100XC installed 2025

Salon

- Large saloon with L-shaped settee
- soft flooring throughout
- 2 barstools at butcher block
- Moveable dining table, seats up to 6 in saloon or cockpit
- New hinges for saloon cabinets (2025)
- Nav station

Galley

- Galley renovated 2023
- 2 drawer Isotherm fridge (new 2020)
- Top load freezer/fridge
- Extra fridge in Port hull
- Portable Gosun Fridge/freezer with own battery, AC/DC connectors (New 2024) extra Freon, pressure test equipment and fans on board.
- Double Stainless steal sink (New 2023)
- Speacial filtered drinking water system at sink
- Saltwater system at sink
- 3 burner propane stove top with spare parts
- Propane oven (new 2020)
- Gosun Fusion Solar oven (new 2024)
- Propane has safety valve and 3 storage tanks.
- single burner induction cooktop (new 2023)
- Custom maple butcher block countertop (new 2020)
- Lots of counter space
- 2 large storage cupboards 4 drawers new hinges and hardware

Cockpit

- Spacious cockpit
- Full cockpit sunshades (new 2023)
- Full cushions from Sunberrla for cockpit and princess seats (new 2023)
- Outdoor carpeting for flooring
- Cockpit opens to saloon
- Hardtop with Sunpower flexible solar panels and water catchment
- Helm seat for 2
- 3 storage lockers
- 2 electric 54 winches
- 2 electric 50 winches
- 1 manual 44 winch
- Moveable wooden table, seats up to 6
- Heavy duty cooler / storage bin
- Dinghy davits rebuilt 2024
- Lewmar traveler and hardware

Electronics

- Raymarine autopilot + entire spare unit including drive, computer and controller ST6002
- Raymarine ES127 chart plotter with both C-map and Navionics charts for the South Pacific, NZ and AU (purchased 2023)
- Raymarine instruments Wind Speed/log i60
- back-up wind transducer with additional i60 display
- extra Rudder sensor
- extra power cable R70029 and sea-talk cables.
- VHF Standard Horizon GX1700
- 3X handheld VHF radios
- AIS Digital Yacht SPL1500 with wifi
- 2x Iridium Go! with external antenna
- Inreach SE
- Starlink Version 3 with power source and router
- Computer running Opencpn with GPS dongle.
- Calypso Ultra Sonic Wind Meter <https://www.calypsosinstruments.com/>

Tender

- OCD (Offshore Cruising Tender) 3.5m (12 ft) Model OC350 www.octenders.co.nz with Fishing Rod holders, Ladder, wheels, custom bow roller, Navigation lights
- replacement non-skid for tender
- custom tender flooring
- two tender anchors
- Yamaha 15hp 4 stroke (new 2020)
- S3213 Fuel water separator (new 2024)
- Dinghy davits
- Spare propeller

Sails & Rigging

- Hydranet mainsail with 3 reefing points
- New reefing lines 2020
- Antal mainsail track reinstalled and

Electrical

- 1490w solar, 7x lightweight flexible SunPower panels (new 2020)
- one flexible and two glass panels (new '24/'25) space and cabling available for 200 more watts of solar
- 5 solar controllers 4 Victron MPPT 100/30 charge controllers with Bluetooth monitoring (new 2020) one portable 30amp controller (2024) which functions as a separate solar system.
- 600 Ah 12v Victron lithium Smart batteries (new 2x2023 1x2024)
- Victron Smart 12/100 BMS (new 2023)
- Spare Victron BMS 12/200
- Victron 500 amp smart shunt (new 2023)
- Victron Battery protect (New 2023)
- All batteries are individually fused with 100 amp fuses.
- 110V Victron IP22 battery charger (new 2023)
- 540Ah 12v lead acid batteries
- 2000w 110v inverter (new 2020) 110v AC throughout vessel can easily be converted to 220v AC
- 2000w 220v inverter (new 2023) 220v power strip at nav station
- LED lights throughout
- Red/White lights in cabins and nav station
- 12v reading lights with red/white + USB charger in cabins

Engines and mechanical

- 2x Yanmar 3gm30: Starboard rebuilt 2024 and Port rebuilt 2025
- Port engine has Balmar serpentine belt
- Both engines have Balmar "Belt Buddy" tension adjusters
- 3x spare alternators
- 3x Spare starters
- spare: head gasket, high pressure fuel

Miscellaneous

- Spectra Ventura 150 12v watermaker, with spare membrane, filters, gasket kit, water testers, new Spare pre-pump
- 3 x Trolling rods with reels, gaff, fish net and tackle
- 2x hard SUP's
- Doutone wing with SUP keel attachment
- 4x heavy duty aluminum surfboard racks
- 7x 20L/ 5gal diesel jerry cans
- 3x 20L/ 5gal gasoline jerry cans
- 4x 20L/ 5galwater jugs
- 4x 15L/4 gal PET drinking water jugs
- Spare pumps (freshwater, bilges, sumps)
- Spare wiring, high amp bus bars, lugs and fuses.
- Spare LED light fixtures
- Spare 12v fans
- small solar oven needs vacuum tube.
- Full range of Tools including 3/8" and 1/2" torque wrenches 1/4", 3/8" and 1/2" socket sets
- 110v power tools (circular saw, saber saw, multi tool, variable speed 6" disc sander, 6" and 9" heavy duty grinders, cordless drill/impact driver), pressure washer
- 220v orbital sander
- 2000w 110v gasoline generator with 30 amp connection
- Spare engine parts (gaskets, raw water pumps, bearing kits for raw water pumps)
- Backup electric raw water system installed for the engine
- New heads and plumbing (2020)
- New spare stainless hardware for chainplates
- 2x spare propellers (2 blade, folding)
- New dishes, pots pans, kitchen utensels and galley equipment 2023
- Customs gauges for engine Temp, Oil pressure and voltage and engine hour 12 counter.

Miscellaneous cont.

- spare Whale BE9003 Electric Field water sensor switches.
- Spare dyneema rope for soft shackles and misc use.
- Foul weather gear, hats etc included.
- 3 wetsuits 2x 5mm suits (new 2024)
- 5 sets + snorkel gear with free dive weights
- Various solar lights
- Flag set
- Printer
- Backup 12v battery charger
- multiple sets of sheets, pillows and bamboo mattress and pillow cover (new 2025)
- Night vision binoculars
- Custom made heavy duty emergency tiller
- 12/24 volt Brass Monkey Ice maker
- goWise USA 5.7 liter (6 quart) electric pressure cooker

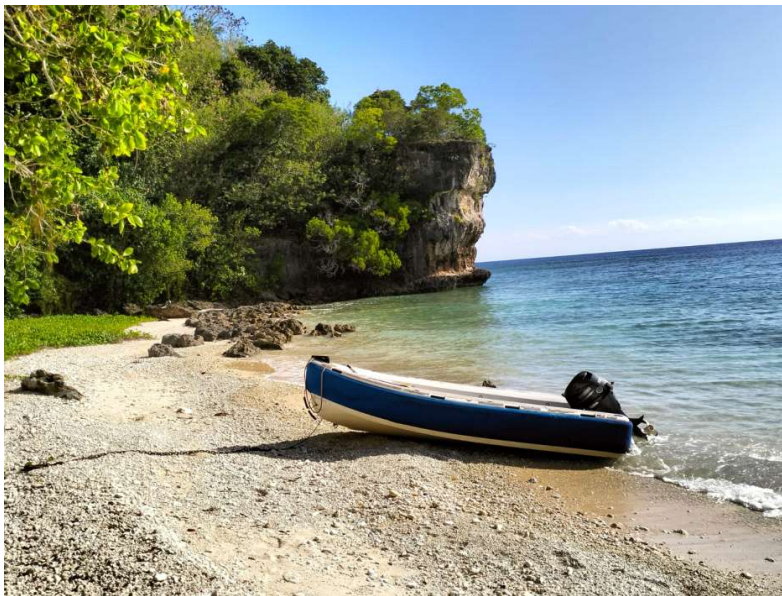





Sea Hunt Marine Brokers

ABN: 89 911 642 354

86 Carlotta St Greenwich, NSW 2065

M| 0411 59 56 57

E| bill@seahuntmarinebrokers.com